



- 开启角度: 105度
- 铰杯厚度: 10.5毫米
- 铰杯直径: 35毫米
- 面板(K)尺寸: 3毫米-7毫米
- 材质: 铁镀镍
- 门可选用板厚: 14毫米-20毫米
- Opening angle: 105°
- Depth of hinge cup: 10.5mm
- Diameter of hinge cup: 35mm
- Drilling distance on the door(K): 3-7mm
- Material: cold rolled steel, nickel plated
- Range of door thickness: 14-20mm

S85系列(卡式调动)自关铰链(两段力)功能图 S85 Installation dimensions (Two way)

D: 盖位计算值表 Overlay
A: 间隙位计算值表 Gap



S85A 全盖 Full overlay

$$H = 13 + K - D$$

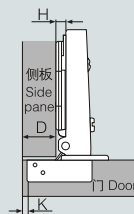

$\begin{matrix} H & K \\ \backslash & / \\ D \end{matrix}$	3	4	5	6	7
0	16	17	18	19	20
2	14	15	16	17	18
4	12	13	14	15	16



S85B 半盖 Half overlay

$$H = 5 + K - D$$

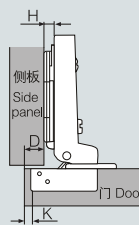

$\begin{matrix} H & K \\ \backslash & / \\ D \end{matrix}$	3	4	5	6	7
0	8	9	10	11	12
2	6	7	8	9	10
4	4	5	6	7	8



S85C 内嵌 Insert

$$H = -2 + K + A$$

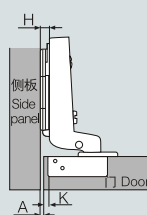

$\begin{matrix} H & K \\ \backslash & / \\ A \end{matrix}$	3	4	5	6	7
0	-1	-2	-3	-4	-5
2	1	0	-1	-2	-3
4	3	2	1	0	-1

铰杯种类 Hinge cup types

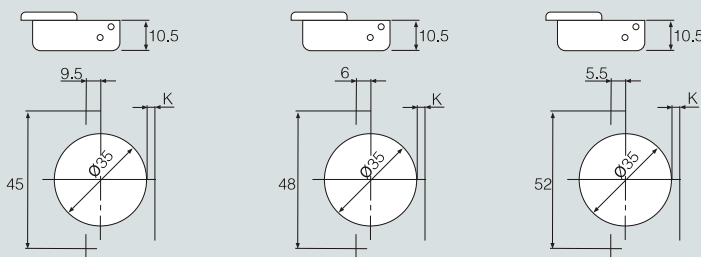

可配底座 Plate

序号 No	名称 Item no.	H值 H Value	孔型/安装尺寸L Hole type/Mounting dimension	类型 type
1	P20B	H=0/3	两孔two holes/37mm	普通卡式Clip on
2	P50B	H=0	四孔four holes/37mm	普通卡式Clip on
3	P60	H=0	四孔four holes/37mm	移动卡式Adjustable

安装尺寸L(Mounting dimension L)

安装尺寸L(Mounting dimension L)

侧板
边沿

侧板
边沿

